

HIGH POWER DIODE LASER

ALC-650-1000-CB

The C-mount is an ideal component for quick prototyping and laboratory setups. However, the maximum output power is typically limited by the inherently sub-optimal heat dissipation properties of the C-mount itself.

Please contact us to discuss the best package option for your application.

Applications

- Medical
- Cr:LiSAF and Cr:LiCAF Solid State Laser Pumping

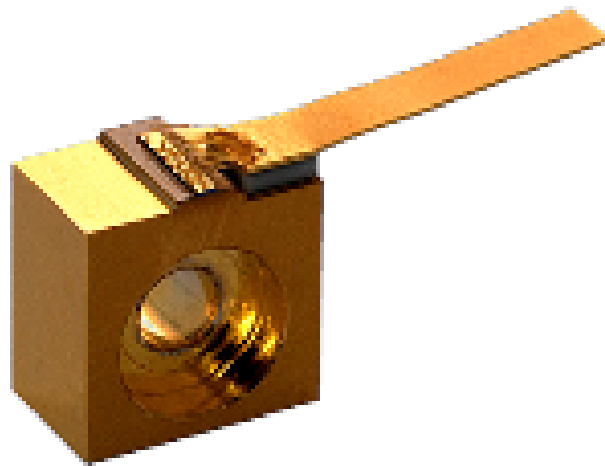

Specifications

| Optical Parameters | Units | |
|---------------------------------|---------|-------|
| Center Wavelength | nm | 650 |
| Wavelength Tolerance | nm | ±5 |
| Spectral Width (FWHM) | nm | 1.0 |
| Wavelength Temp. Coefficient | nm/°C | 1.2 |
| Output Power | mW | >1000 |
| Operating Current | mA | 1700 |
| Operating Voltage | V | <2.2 |
| Threshold Current | mA | 700 |
| Emitter width | µm | 150 |
| Beam divergence fast axis, FWHM | degrees | 40 |
| Beam divergence slow axis, FWHM | degrees | 7 |

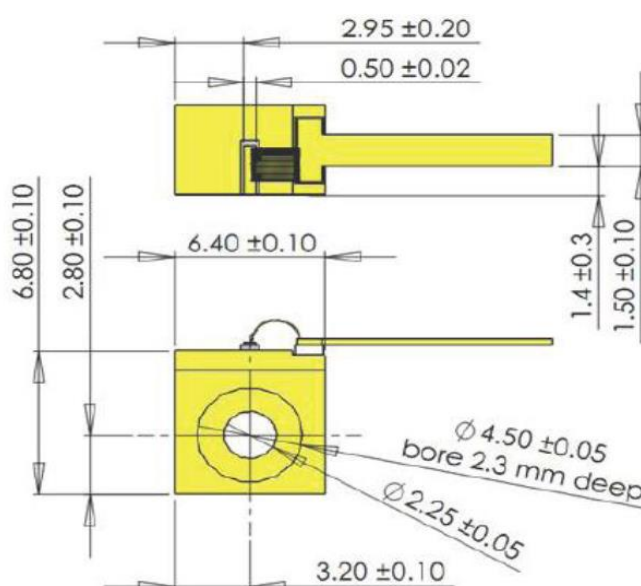
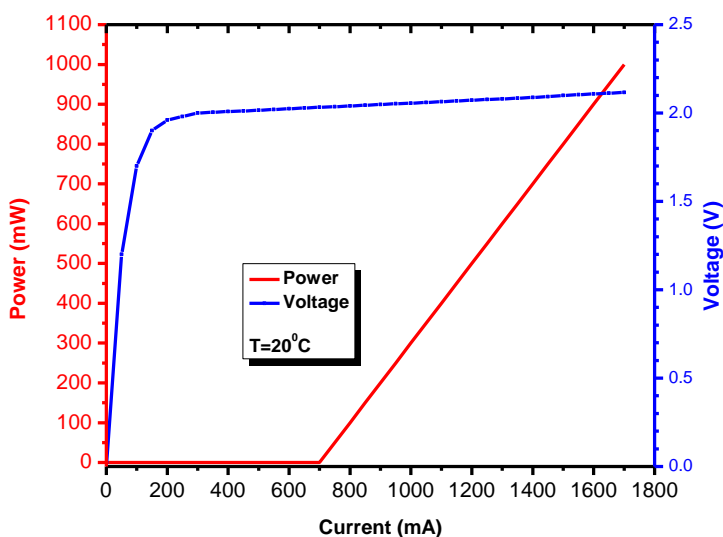

These components do not comply with the Federal Regulations (21 CFR Subchapter 1) as administered by the Center for Devices and Radiological health.

Purchaser acknowledges that his/her products must comply with these regulations before they can be sold.

Akela laser Corporation reserves right to change any specifications.